

TO LET

FITTED RETAIL UNIT

OF U18 (GROUND FLOOR)
ST. ENOCH CENTRE, GLASGOW

ST·ENOCH



Location

St. Enoch Centre is located at the junction of Buchanan and Argyle Street, in the heart of Glasgow, which is the UK's strongest retail destination outside of London. The Centre extends to 880,000 sq ft and is home to a range of popular brands including **H&M**, **Boots**, **Samsung**, **Schuh Kids**, **Swarovski**, **Tesco** and **Chocolat**. With 11 new brands (140,000 sq ft) opening 2021, St Enoch is transforming to become the best shopping and leisure hub in Glasgow city centre with the arrival of **Vue Cinemas**, **TJ Hughes**, **Gutterball**, **Boom Battle Bar**, **Hamleys**, **Cosmo**, **Nando's**, **Donut** and **Gloria Jeans**.

Description

The subjects comprise a fully fitted unit arranged over a single level.

Terms

The unit is available on a new lease for a negotiable duration. Rental information is available on request.

EPC

Full Energy Performance Certificate is available upon request.

Costs

Each part is to bear their own legal and other professional costs incurred in the transaction.

Accommodation

Ground Floor	2,766 sq ft	257 sq m
--------------	-------------	----------

Business Rates & Service Charge

Rateable Value	TBC
Rates Payable 2021 / 2022	TBC
Service Charge (Estimate)	£31,533 pa

0F U18 (Ground Floor) St. Enoch Centre, Glasgow

ST·ENOCH

GROUND FLOOR

■ Unit 18

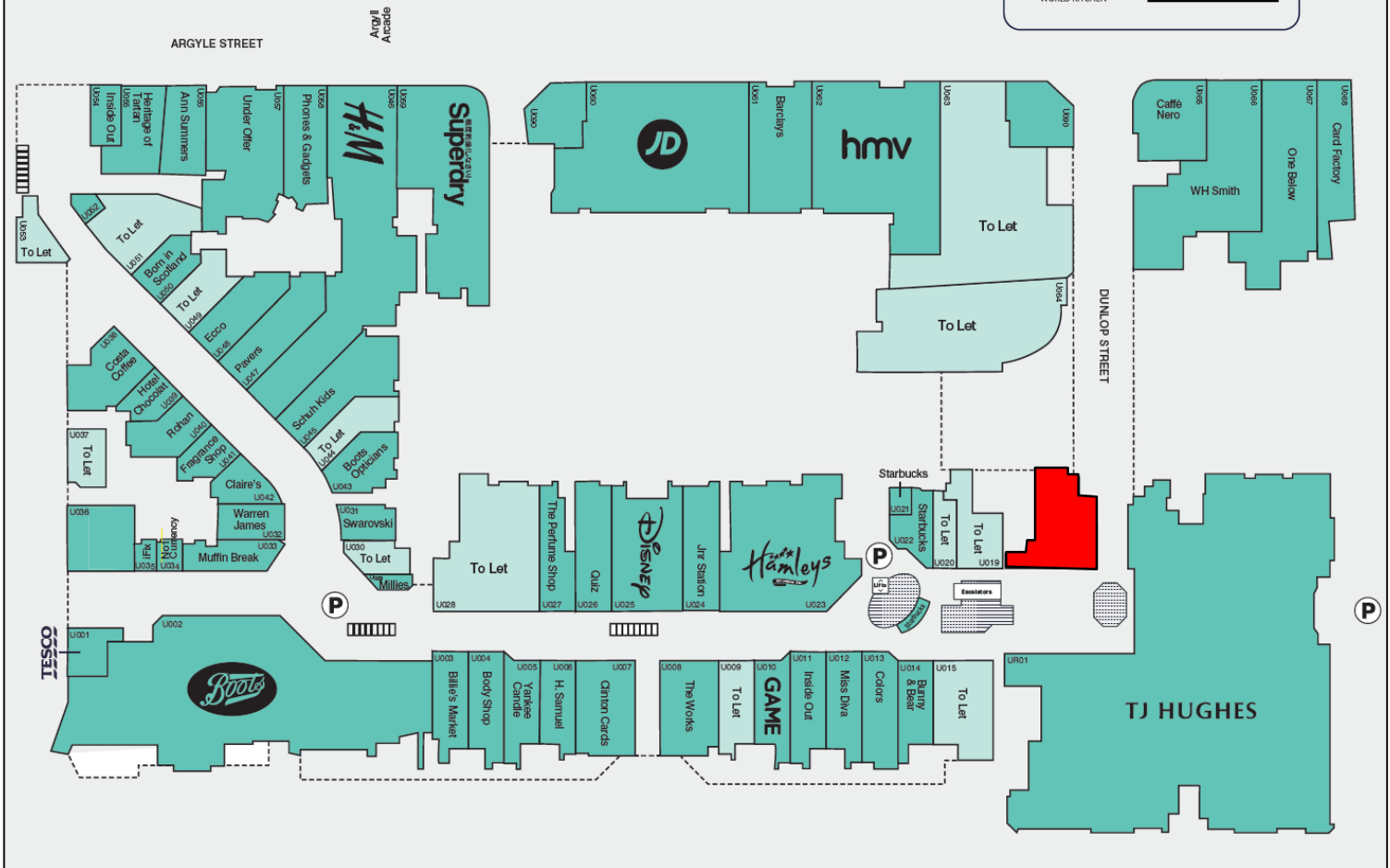

OPENING 2021

TJ HUGHES **vue**

Nando's

COSMO[®]
AUTHENTIC WORLD KITCHEN

**** GUTTER BALL ****

For further information, please contact the joint letting agents:

Stuart Moncur
0131 247 3706
stuart.moncur@savills.com

James Dickinson
0141 222 4139
James.dickinson@savills.com

Ian Whelan
0131 558 4121
iwhelan@eyco.co.uk

John Menzies
0141 222 4126
john.menzies@savills.com

Kevin Hughes
0131 558 5142
khughes@eyco.co.uk

goad network
For more information on our products and services:
www.goadplans.co.uk
0845 6016011
goad.sales@uk.experian.com

COPYRIGHT AND CONFIDENTIALITY NOTICE
2020 Experian Ltd All Rights Reserved
This product includes mapping data licensed from Ordnance Survey © Crown Copyright 2008. Licence number PU 100017295.
For full terms & copyright conditions visit www.goadplans.co.uk

Savills Glasgow
savills.co.uk savills
0141 248 7342

eyco
CHARTERED SURVEYORS
0131 226 2641
www.eyco.co.uk

Savills, their clients and any joint agents give notice that:

1. They are not authorised to make or give any representations or warranties in relation to the property either here or elsewhere, either on their own behalf or on behalf of their client or otherwise. They assume no responsibility for any statement that may be made in these particulars. These particulars do not form part of any offer or contract and must not be relied upon as statements or representations of facts.
2. Any areas, measurements or distances are approximate. The text, photographs and plans are for guidance only and are not necessarily comprehensive. It should not be assumed that the property has all necessary planning, building regulation or other consents and Savills have not tested any services, equipment or facilities. Purchasers must satisfy themselves by inspection or otherwise. August 2021.