

TO LET

FITTED RETAIL UNIT

0F U20 (GROUND FLOOR)  
ST. ENOCH CENTRE, GLASGOW

ST·ENOCH

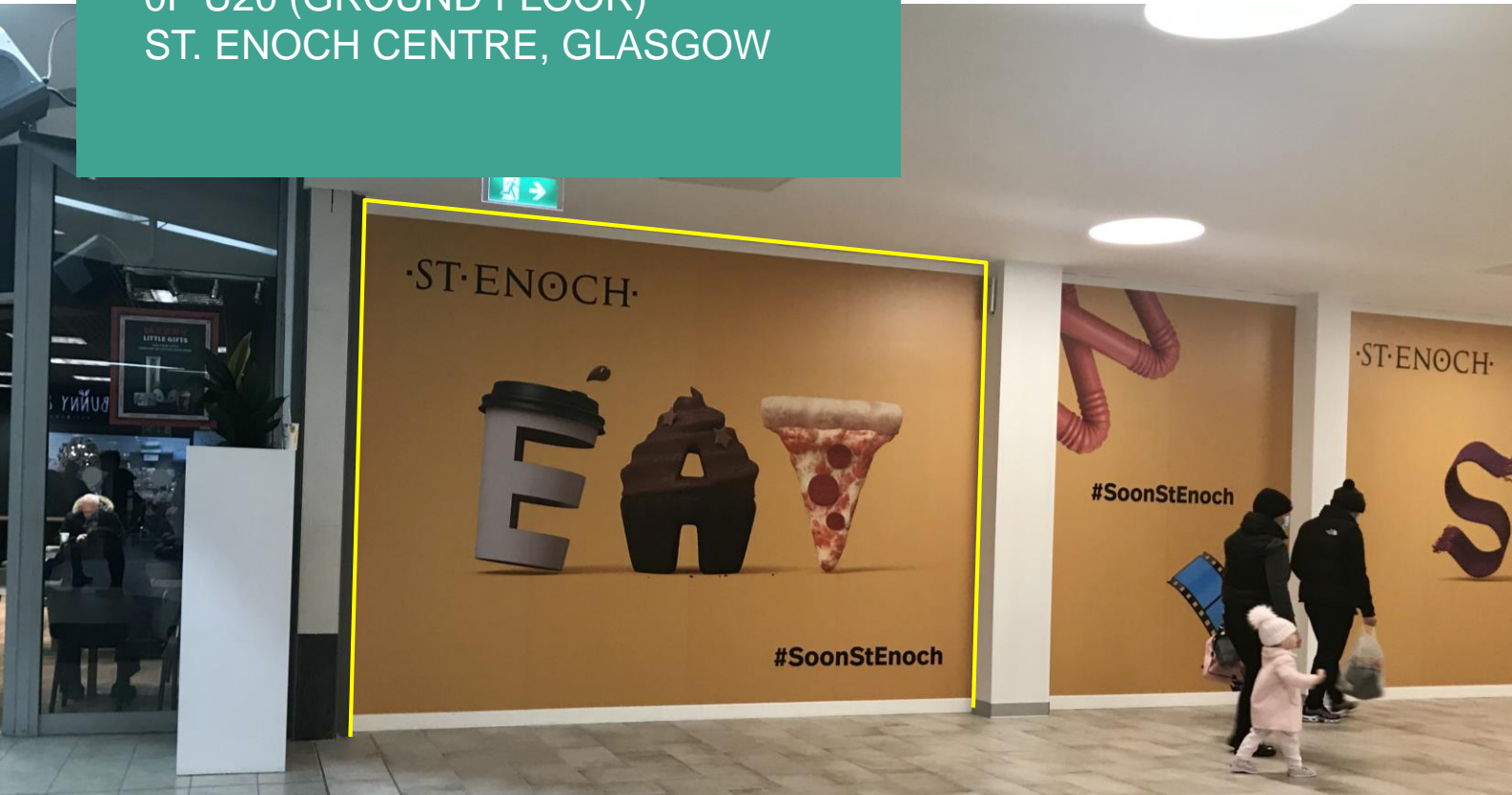

### Location

St. Enoch Centre is located at the junction of Buchanan and Argyle Street, in the heart of Glasgow, which is the UK's strongest retail destination outside of London. The Centre extends to 880,000 sq ft and is home to a range of popular brands including **H&M, Boots, Samsung, Schuh Kids, Swarovski, Tesco** and **Hotel Chocolat**. With 11 new brands (140,000 sq ft) opening in 2021, St Enoch is transforming to become the best shopping and leisure hub in Glasgow city centre with the arrival of **Vue Cinemas, TJ Hughes, Gutterball, Boom Battle Bar, Hamleys, Cosmo, Nando's, Donut King** and **Gloria Jeans**.

### Description

The subjects comprise a fully fitted unit arranged over a single level.

### Terms

The unit is available on a new lease for a negotiable duration. Rental information is available on request.

### EPC

Full Energy Performance Certificate is available upon request.

### Costs

Each part is to bear their own legal and other professional costs incurred in the transaction.

### Accommodation

Ground Floor	650 sq ft	60 sq m
--------------	-----------	---------

### Business Rates & Service Charge

Rateable Value	TBC
Rates Payable 2021 / 2022 2022	TBC
Service Charge (Estimate)	£7,713 pa

# 0F U20 (Ground Floor) St. Enoch Centre, Glasgow

# ST·ENOCH

## GROUND FLOOR

■ Unit 20

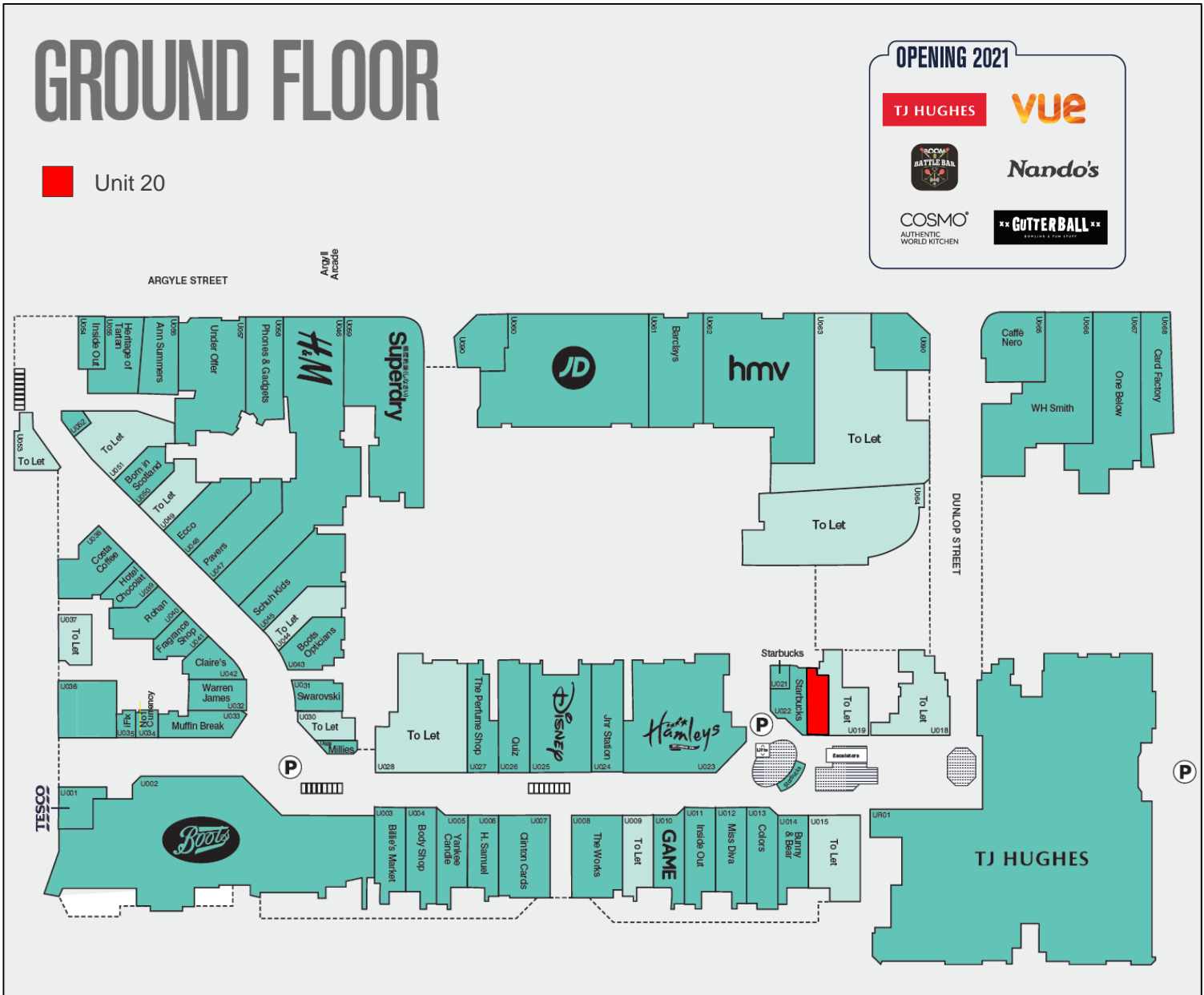

**OPENING 2021**

**TJ HUGHES** **vue**

**ROCKWELL BATTLE BAR** **Nando's**

**COSMO** AUTHENTIC WORLD KITCHEN **xx GUTTER BALL xx**

For further information, please contact the joint letting agents:

Stuart Moncur  
0131 247 3706  
stuart.moncur@savills.com

James Dickinson  
0141 222 4139  
james.dickinson@savills.com

Ian Whelan  
0131 558 4121  
iwhelan@eyco.co.uk

John Menzies  
0141 222 4126  
john.menzies@savills.com

Kevin Hughes  
0131 558 5142  
khughes@eyco.co.uk

**goad** network  
For more information on our products and services:  
[www.goadplans.co.uk](http://www.goadplans.co.uk)  
0845 6016011  
[goad.sales@uk.experian.com](mailto:goad.sales@uk.experian.com)

**COPYRIGHT AND CONFIDENTIALITY NOTICE**  
2020 Experian Ltd All Rights Reserved  
This product includes mapping data licensed from Ordnance Survey © Crown Copyright 2008. Licence number PU 100017395.  
For full terms & copyright conditions visit [www.goadplans.co.uk](http://www.goadplans.co.uk)

Savills Glasgow **savills** **eyco** CHARTERED SURVEYORS  
**0141 248 7342** **0131 226 2641**  
[www.eyco.co.uk](http://www.eyco.co.uk)

Savills, their clients and any joint agents give notice that:

- They are not authorised to make or give any representations or warranties in relation to the property either here or elsewhere, either on their own behalf or on behalf of their client or otherwise. They assume no responsibility for any statement that may be made in these particulars. These particulars do not form part of any offer or contract and must not be relied upon as statements or representations of facts.
- Any areas, measurements or distances are approximate. The text, photographs and plans are for guidance only and are not necessarily comprehensive. It should not be assumed that the property has all necessary planning, building regulation or other consents and Savills have not tested any services, equipment or facilities. Purchasers must satisfy themselves by inspection or otherwise. August 2021.