



Two new prime
retail units available

alongside the new River Island and opposite the new Next store

Thistles

STIRLING

Stirling is a major regional centre in the central belt of Scotland, with a catchment of 115,000 people living within 15 minutes. The city is situated approximately 40 miles from Edinburgh and 35 miles from Glasgow. Thistles Shopping Centre provides more than 500,000 sq ft of quality retail space with key anchor stores including M&S, Zara and Primark.

Units 32 and 34 are located on the prime section of Kings Mall adjacent to River Island, opposite the entrance to Debenhams and close to other retailers including Next and Boots.

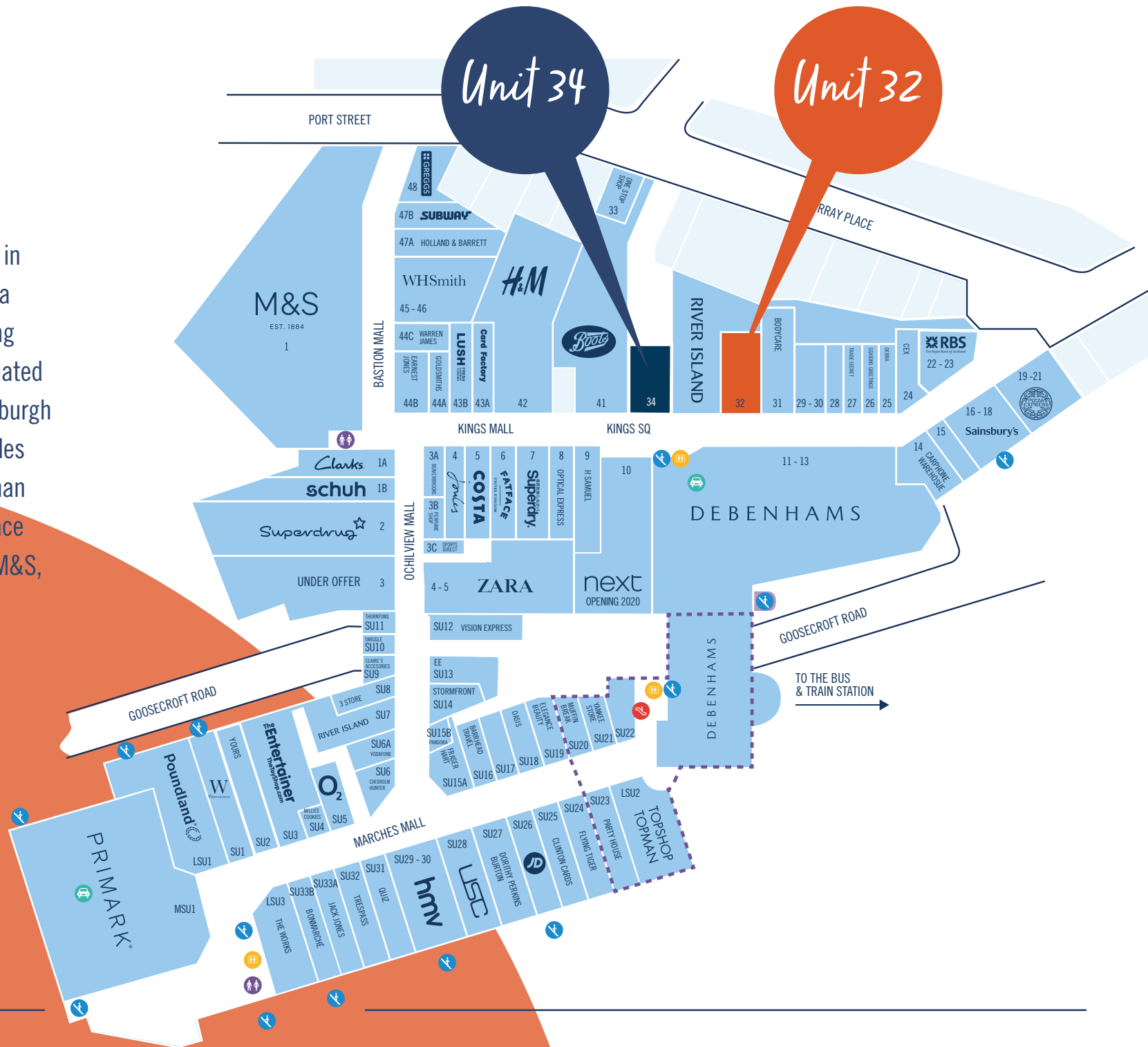



STIRLING

Unit 32	
Ground Floor	975 sq ft
Basement	1,113 sq ft
Quoting Rent	£50,000 per annum exclusive of VAT
Rates	To be assessed upon completion of sub-division works
Service Charge	£17,685

Unit 34	
Ground Floor	1,055 sq ft
Basement	875 sq ft
Quoting Rent	£55,000 per annum exclusive of VAT
Rates	To be assessed upon completion of sub-division works
Service Charge	£16,347

Mall Level

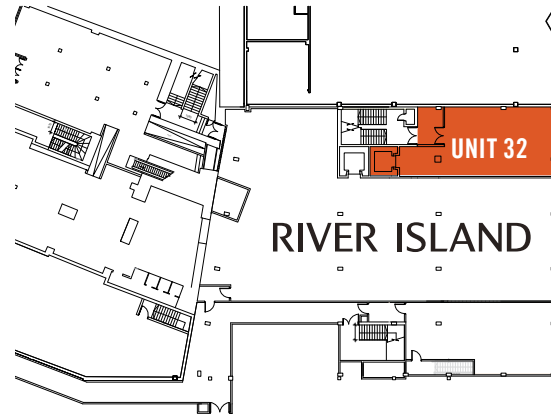

Basement Level

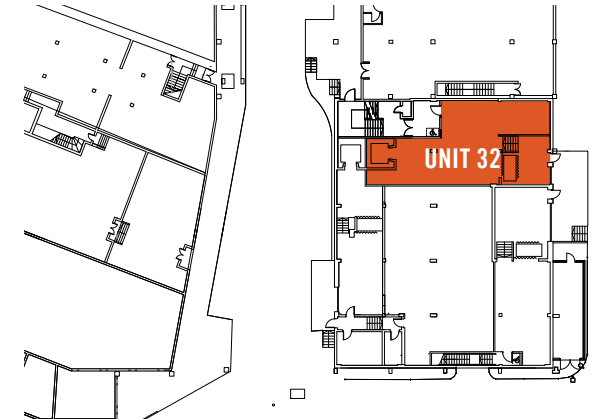

Mall Level

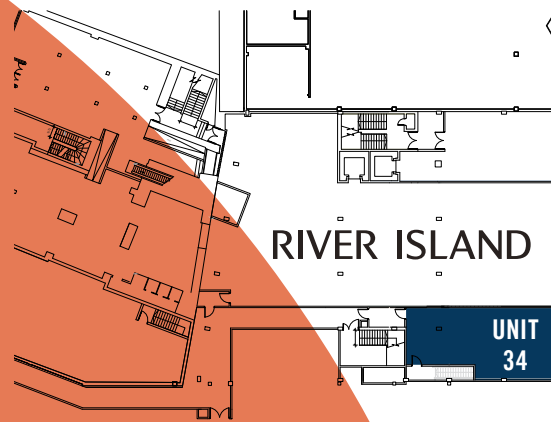

Basement Level

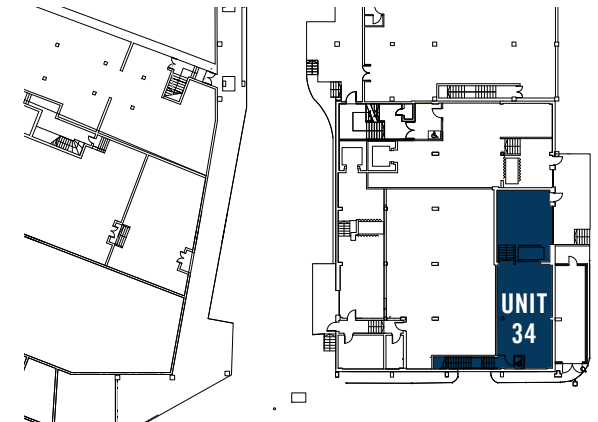



Average dwell time is
76 minutes

SOURCE: Javelin Thistles 2018 Off-peak Consumer Survey

Average footfall of
9 million
per annum

SOURCE: Footfall Experian 2018

Average spend
per visit is

£52

SOURCE: Javelin Thistles 2018
Off-peak Consumer Survey

34,100 students
in Thistles catchment

SOURCE: CACI March 2018

31% of Thistles catchment
are affluent shoppers

SOURCE: CACI Retail Footprint 2017

70 tenants

Top 100
UK retail venue

SOURCE: Javelin Venuescore 2017

People visit

1.3 times
per month

SOURCE: Javelin Thistles 2018 Off-peak Consumer Survey

The size of the scheme is over

500,000 sq ft

Tenants include River Island, Zara, Next, Primark, M&S and Joules

CHARTERED SURVEYORS
0131 226 2641
www.eyco.co.uk

Wemyss House
8 Wemyss Place
Edinburgh
EH3 6DH
savills.co.uk/retail
0131 247 3800

EYCO LLP and Savills for themselves and for their client whose agent they are give notice that (1) These particulars are set out as a general outline only for the guidance of intended purchasers or tenants and do not constitute any or part of an offer or contract. (2) All descriptions, dimensions, reference to condition and necessary permissions for use and occupation and other details are given without responsibility and any intending purchaser or tenant should not rely on them as statements or presentations of fact but must satisfy themselves by inspection or otherwise as to the correctness of each of them. (3) No person in the employment of EYCO LLP or Savills have any authority to make or give representation or warranty whatever in relation to this property. (4) Unless otherwise stated all prices and rents are quoted exclusive of VAT. Prospective purchasers or lessees must satisfy themselves independently as to the incidence of VAT in respect of any transaction.