

TO LET

Unit 14A Fife Leisure Park
Dunfermline KY11 8EX

- ▶ Leisure unit
- ▶ Prime leisure park in Fife
- ▶ 11,000 sq ft plus potential mezzanine
- ▶ 1,500 car parking spaces



LOCATION

Dunfermline is one of Scotland's fastest growing towns with a population of over 56,000. Fife Leisure Park is located east of Dunfermline town centre, immediately adjacent to the M90 motorway. Fife Leisure Park is one of the largest leisure parks in Scotland, with over 250,000 sq ft of leisure and retail accommodation.

Anchored by **Odeon Cinema** and a 50,000 sq ft **Dobbie's Garden World**, Fife Leisure Park is one of the largest in Scotland with over 250,000 sq ft of leisure and retail accommodation. Nearby occupiers include **Hollywood Bowl, Nando's, Odeon Cinema, Frankie & Benny's, Pizza Hut** and **Bannatynes Health Club**.

ACCOMMODATION

The unit sits adjacent to Carlton Bingo and comprises a large retail unit arranged over a ground floor only, extending to the following approximate net internal floor area:

TOTAL FLOOR AREA	11,000 SQ FT	1,022 SQ M
------------------	--------------	------------

PLANNING

We have been verbally advised by the Local Planning Authority that the subjects currently benefit from Class 11 consent and can therefore be used for leisure use. Interested parties are advised to speak directly to the Local Planning Authority.

LEASE

The subjects are available on the basis of a new full repairing and insuring lease subject to 5 yearly upward only rent reviews.

RENT

On application.

RATING

To be assessed.

ENERGY PERFORMANCE CERTIFICATE

Available on request.

DATE OF ENTRY

By arrangement.

LEGAL COSTS

Each party to be responsible for their own legal costs incurred during the transaction. For the avoidance of doubt the ingoing tenant will be responsible for Land and Buildings Transaction Tax (LBTT), registration dues and any VAT payable thereon.

VIEWING

Viewings are strictly by prior arrangement with EYCO on 0131 226 2641.



Proposed Elevation

TO LET

Unit 14A Fife Leisure Park
Dunfermline KY11 8EX

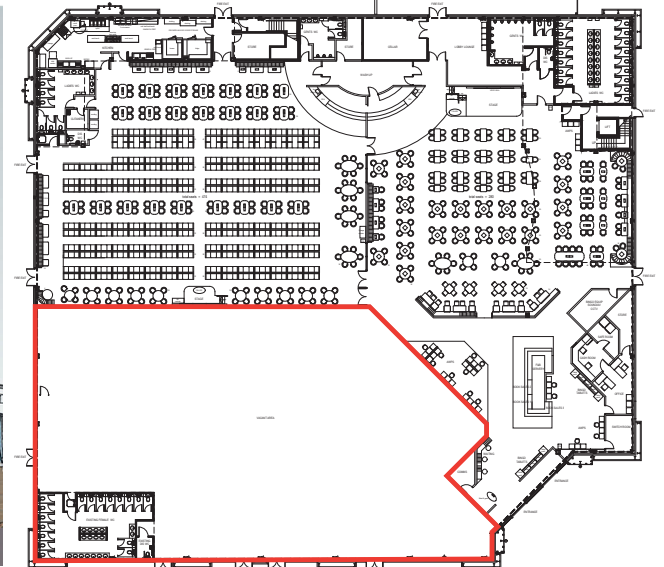
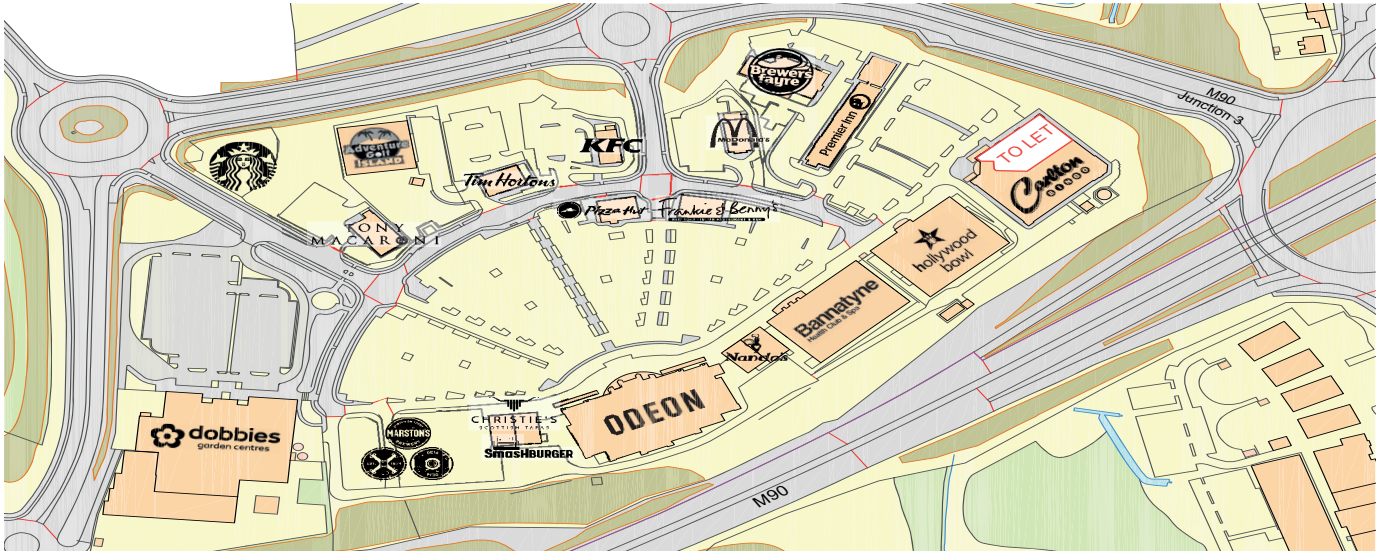

Goad Digital Plans are for identification only and not to be scaled as a working drawing and are based upon the Ordnance Survey Map with the permission of The Controller of Her Majesty's Stationery Office © Crown Copyright 39954X. No part of this plan may be entered into an electronic retrieval system without prior consent of the publisher.

GET IN TOUCH



Simon Bashford
sbashford@eyco.co.uk
07799 891 273
0131 558 5118



Callum Keane
ckeane@eyco.co.uk
07714 569 190
0131 558 5107

SXB/JH/DUN327 - Date of publication: 18 May 2023

EYCO LLP for themselves and for their client whose agent they are give notice that (1) These particulars are set out as a general outline only for the guidance of intended purchasers or tenants and do not constitute any or part of an offer or contract. (2) All descriptions, dimensions, reference to condition and necessary permissions for use and occupation and other details are given without responsibility and any intending purchaser or tenant should not rely on them as statements or presentations of fact but must satisfy themselves by inspection or otherwise as to the correctness of each of them. (3) No person in the employment of EYCO LLP has any authority to make or give representation or warranty whatever in relation to this property. (4) Unless otherwise stated all prices and rents are quoted exclusive of VAT. Prospective purchasers or lessees must satisfy themselves independently as to the incidence of VAT in respect of any transaction.